



# Tip Lift: LD1-3

**Smooth, Safe, Efficient**



The Tilt-Lock model LD1-3 Tip Lift is designed to handle light rolls of paper up to 340 lbs. The lightweight model utilizes ergonomically designed handles and controls featuring interlocking safety switches. The LD1 is equipped with a short probe and manual tooth release. This unit is perfect for handling small rolls in areas with low headroom.

#### Features:

- Light-weight at 67 lbs.
- Interlocking switches requiring both hands on handles for operation
- Fuse / power control
- Adjustable ergonomic handles
- Manual tooth release
- Short probe
- Power: 115 / 1 / 60 5.5 amps
- Controls are dual interlock, hoist up, hoist down, tip up and tip down

*For additional information, write or call*



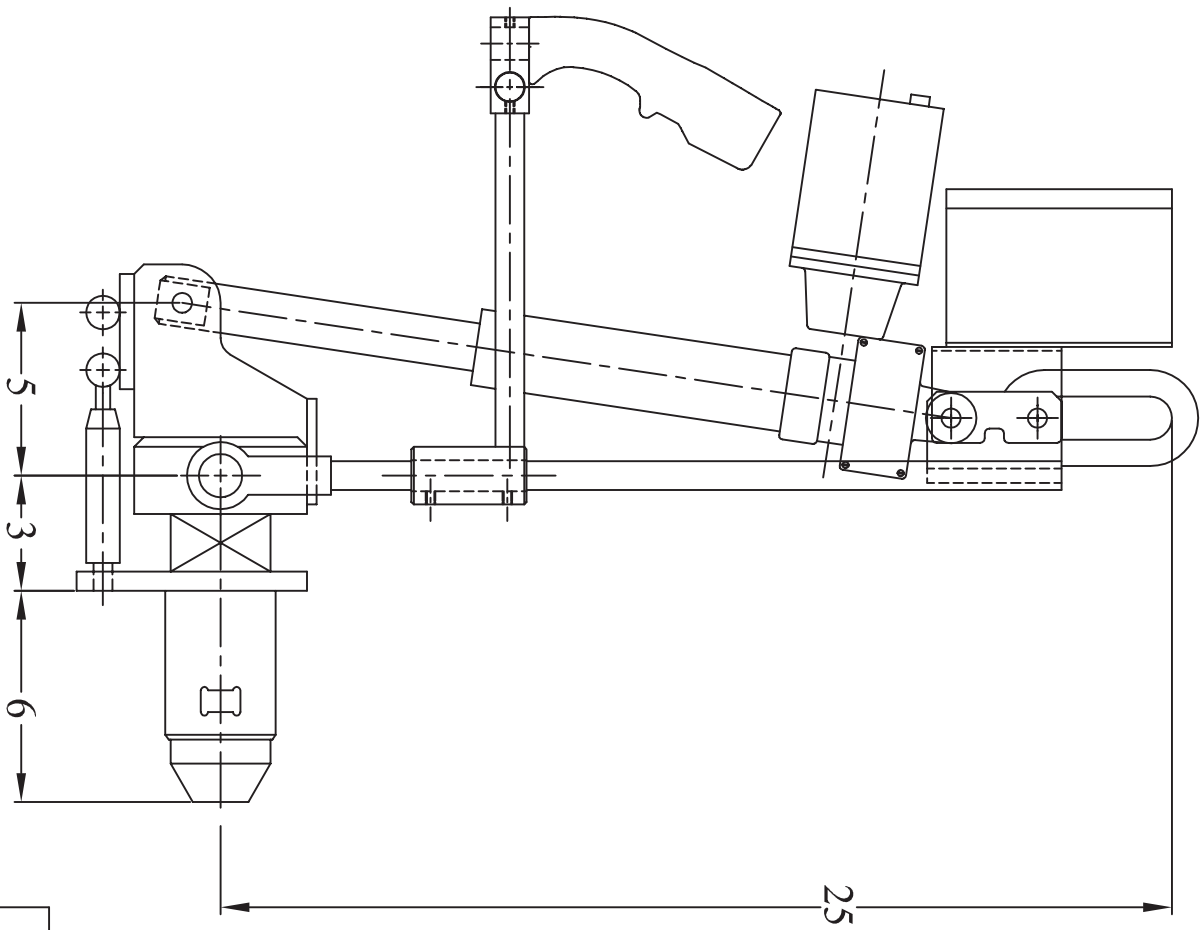

LD-1 Electric Tip Lift Cap.			
Roll Width	Max. Wt. (lbs.)	Roll Width	Max. Wt. (lbs.)
4	344	16	156
6	287	18	143
8	246	20	132
10	215	22	123
12	191	24	115
14	172		

**POWER: 115 VOLTS SINGLE PHASE 5.5 AMPS**

**CONTROLS: DUAL SAFETY INTERLOCK**  
**HOIST RAISE**  
**HOIST LOWER**  
**TIP UP**  
**TIP DOWN**

TOLERANCES UNLESS SPECIFIED	
MACHINED XXXX	- ±.005"
.XX	- ±.01"
X	- ±.05"
FRACTIONS	- ±1/16"
ANGULAR	- ±.3°

REV	DATE	BY	CHANGES

NOTICE TO PERSONS RECEIVING THIS DRAWING AND/OR TECHNICAL INFORMATION: TILT-LOCK CLAIMS PROPRIETARY RIGHTS TO THE MATERIAL DISCLOSED THEREON. THIS DRAWING AND/OR TECHNICAL INFORMATION IS ISSUED IN CONFIDENCE FOR ENGINEERING INFORMATION ONLY AND MAY NOT BE REPRODUCED OR USED TO MANUFACTURE ANYTHING SHOWN OR REFERRED TO HEREON WITHOUT DIRECT WRITTEN PERMISSION FROM TILT-LOCK TO THE USER.

TILT-LOCK IS NOT RESPONSIBLE FOR THE STRENGTH OF BUILDING MEMBERS FURNISHED BY OTHERS.

**TILT-LOCK**  
 12070 43RD STREET NE  
 ST. MICHAEL, MN 55376  
 PH: 763-497-7045  
 FAX: 763-497-7046

TITLE: **LD1 AND CAPACITY CHART**

DRAWN BY:	DATE:	SCALE:	WEIGHT:
TGK	9/17/01	NONE	X
RELEASED BY:	DWG.	LD1 CAPACITY	
		SIZE:	REV.
		B	